

Immunotube

(#43005/43015/43055)

1. Description

SPL Life Sciences provides immunotube for diagnostics and immunological purposes.

Materials

PS: Commonly used and transparent. Withstands weak acids and bases.

PP: With high chemical resistance, it withstands acids and bases at room temperature and is harness.

- **Maxibinding** : Modified polystyrene surface for higher binding capacity for proteins and other molecules with both hydrophilic and hydrophobic regions. (Recommended for most ELISA experiments)
- **Unibinding** : Suitable for adsorption of hydrophobic molecules. (Antigen ELISA)

2. Features

- ❖ 2 type surface
- ❖ For immunoassay (ELISA, RIA)
- ❖ High optical quality

3. Product Range

Cat. No.	Material	Surface Type	External Dimension (mm)	Total Vol. (ml)	Units per Sleeve/Case
43005	PS	Unibinding	12.00 x 75.00	5	250 / 2000
43015	PS	Maxibinding	12.00 x 75.00	5	250 / 2000
43055	PP	Unibinding	12.00 x 75.00	5	50 / 500

4. Certification

SPL Life Sciences hereby certifies that the product identified above, inspected to be in compliance with product quality specification and requirements as documented in our ISO 9001:2015 Quality Management System (K-QA-Q031478) in Korea.

5. Specifications & Technical Drawing

(1) Immunotube, PS (#43005/43015)

- Specifications

Dimensions		Material (Resin)	Packaging
Diameter	12.00 Ø	polystyrene (PS)	<ul style="list-style-type: none"> ▪ Pieces/Sleeve: 250 ▪ Pieces/Case: 2000
Height:	75.00 mm		

- Technical Drawing

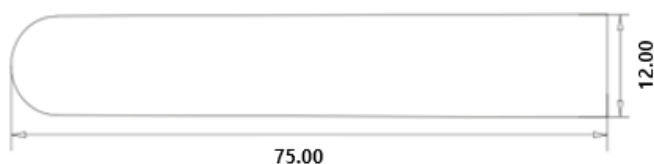

SPL-TDS-IT

(2) Immunotube, PP (#43055)
 - Specifications

Dimensions	Material (Resin)	Packaging
Diameter 12.00 Ø Height: 75.00 mm	polypropylene (PP)	<ul style="list-style-type: none"> ▪ Pieces/Sleeve: 50 ▪ Pieces/Case: 500

- Technical Drawing

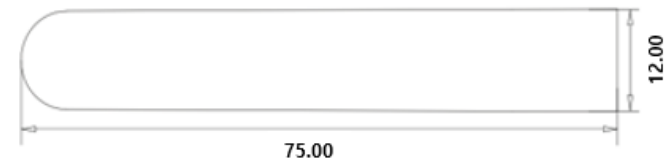

www.spllifesciences.com

For technical assistance, contact SPL R&D Center at:
 Tel: +82-31-533-4800; Fax: +82-31-533-1430; e-mail: spl@ispl.co.kr
 To place an order, contact your local distributor or
 Tel: +82-31-533-4800; Fax: +82-31-533-1430; e-mail: business@ispl.co.kr

SPL-TDS-IT